

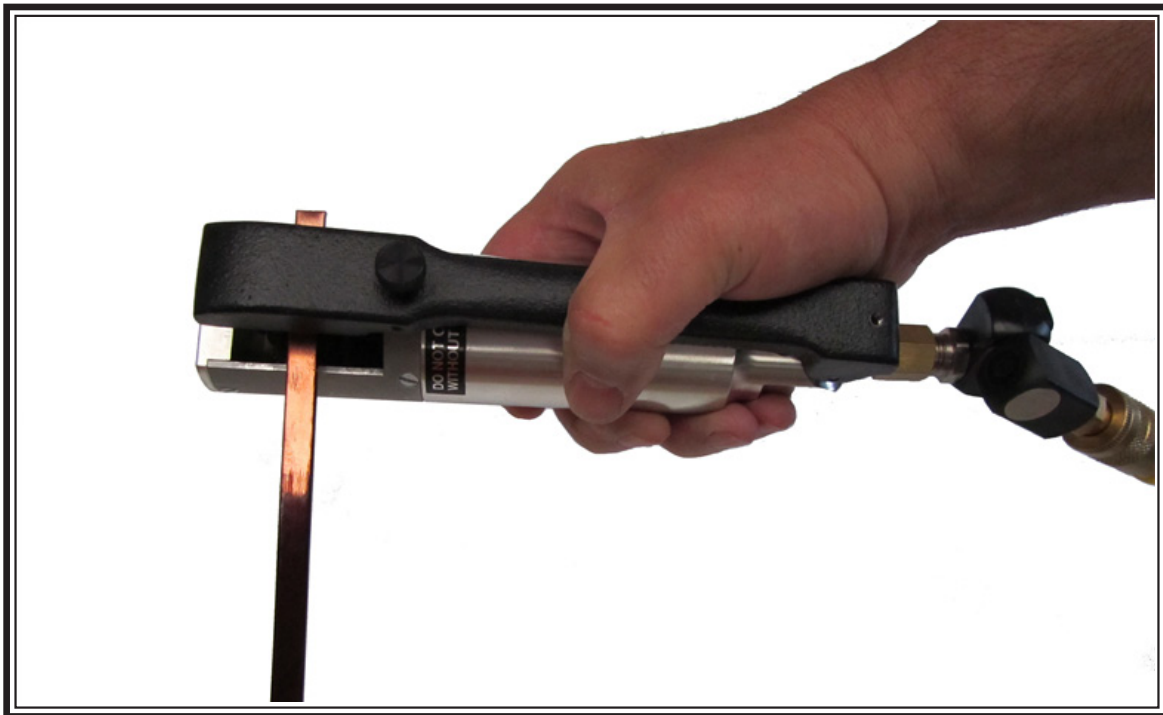

Operating Manual

Please Read Before Operating Unit



RUSH MODEL PD9 PORTABLE WIRE STRIPPER

Please Call for Service or Spare Parts

The Eraser Company, Inc.
PO Box 4961/ Oliva Drive
Syracuse, NY 13221, USA

Phone: (315) 454-3237
Fax: (315) 454-3090
Website: www.eraser.com
E-mail: info@eraser.com



Portable Stripper for Large Magnet Wires

FEATURES

- Air Operated for continuous use
- Weighs only 2 lbs.
- Adjustable clamping assembly

ADVANTAGES

- Reduces operator fatigue
- Robustly built for production
- Can strip ends or windows

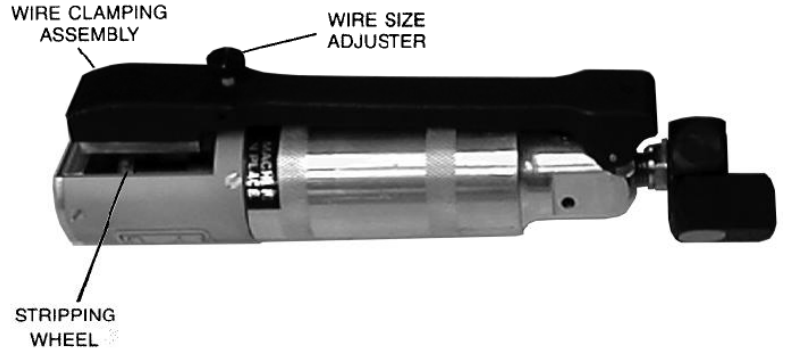

A compact lightweight portable tool designed to strip film type insulations from round and rectangular wires used in the manufacture of transformers, motors, armatures, coils etc.. This robust continuously rated unit will remove tough insulations such as epoxy and glass quickly and effectively. Insulation is quickly removed by a high speed rotating wire brush. The wire to be stripped is positively held in contact with the brush by a hardened steel pad in the custom designed clamping assembly.

The tool may be adjusted for minimal marking of the conductor or to produce a roughened stripped surface to aid subsequent soldering operations. There is no limit to strip length and windows of insulation may be stripped if taps are required. Optional accessories for the PD9 include fiberglass wheels for stripping small wires.

The PD9 requires a clean lubricated air supply at 90 P.S.I. capable of delivering 32 C.F.M.

For a free application evaluation, send 3 - 5 feet of wire with stripping specifications to our Customer Service Department. See form at back of catalog for details.

ORDERING INFORMATION

- AR4000 (PD9) Portable air operated wire stripper complete with 6' (1.8M) of 3/8" (9.5mmØ) diameter air hose, and 5/64" adjusting allen wrench.
- AC1226..... One each GR1006P wire brush**
- AC1229..... One each GR1008P wire brush**
- AC1232..... One each GR1011P wire brush**
- AE0004.... One pair GR201PM Fybrglass stripping wheels
- AE0006.... One pair GR553PM Fybrglass stripping wheels
- AR2701..... Wheel dresser and handle, necessary to dress Fybrglass wheels
- AR2702..... Packet of 10 wheel dressers for AR2701
- PR0003..... Combination air filter, regulator and lubricator
- TG0828..... Replacement brush retainer spindle nut
- TR8285 Replacement hardened steel clamping pad

**Four per unit required

Service and all spare parts available.

SPECIFICATIONS:

Model — PD9

Wire Sizes

- Round 4 AWG to 32 AWG (5.18 - 0.20mmØ)
- Square & Rectangular...Up to 1/4" x 3/4" (6.35mm x 19.05mm)
- Strip Length Unlimited
- Power 15,000 R.P.M., .9 H.P. air motor requiring 90 P.S.I. and 32 C.F.M
- Size7-1/2" x 1-3/4" x 3" (190.5mm x 44.5mm x 76.2mm)
- Weight 2 lbs. (0.91 Kg)

Stripping Wheel Specifications

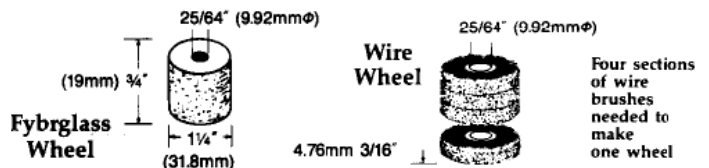

Wheel Grades

Wire Brush Wheels—Use for larger than 23AWG (0.56mmØ) wires

- GR1006P (made from 0.006" (.18mm) steel wire) for fine wires
- GR1008P (made from 0.008" (.20mm) steel wire) for medium wires
- GR1011P (made from 0.0118" (.30mm) steel wire) for large wires

Fybrglass Wheels—Use for smaller than 24AWG (0.51mmØ) wires

- GR201PM Coarse for large wires
- GR553PM General purpose for medium wires

OPERATION:

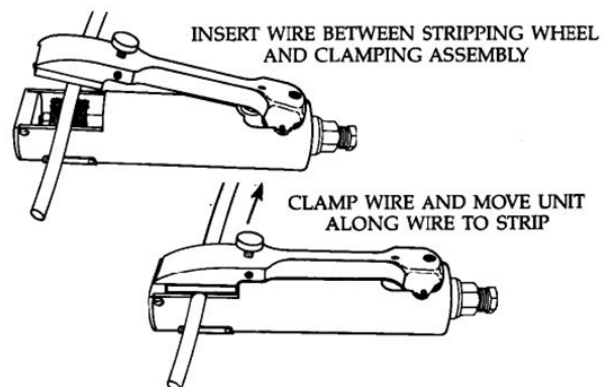

Model PD9 AIR-OPERATED PORTABLE WIRE STRIPPER

SET-UP: (Reference the diagram on page 5 for item callouts)

The Model PD9 is supplied with 6' (1.8 meters) of air hose and one (1) adjusting allen wrench for the set screw (item 10), which locks the clamping assembly adjustment screw and the handle position set screw (item 22). A clean lubricated air supply of 90psi, with 32 CFM per minute is necessary for proper operation. The air supply must contain a Regulator/Filter/Lubricator. If it does not, the Eraser P/N PR0003 unit may be purchased as an optional accessory to be placed between the air supply source and the air hose of the PD9.

Before connecting the PD9 to the air supply, stripping wheels must be installed. To install the wheels, remove the three (3) screws (item 15) holding the guard onto the unit. Remove the guard (item 2) exposing the spindle arbor and spindle nut (items 3 & 14). While holding the spindle in place with a 7/16" wrench, use a 9/16" wrench to remove the spindle nut. Slide four wheel sections or one Fybrglass® wheel (item 20) onto the spindle. Replace and tighten the spindle nut and replace the guard.

The clamping assembly adjustment screw (item 7) is located on the top of the handle (item 4) of the PD9. This adjustment screw setting is locked in place by a set screw located on the side of the handle (item 10). Loosen the set screw by turning it counter-clockwise. The adjustment screw can now be turned freely. Insert the wire to be stripped between the stripping wheels and the clamping pad (item 6). Depress the handle and set the adjustment screw so that the clamping pad holds the wire in place against the stripping wheels. Tighten the locking set screw to lock the setting in place.

! CAUTION: NEVER OPERATE THE PD9 AT AIR PRESSURE HIGHER THAN 90 PSI. WEAR APPROPRIATE SAFETY GEAR INCLUDING FACE SHIELD AND SAFETY GLASSES.

The PD9 may now be connected to the air supply. First attach the supplied air hose assembly (item 19) to the hand tool by attaching the quick disconnect coupling (item 8) of the hose assembly to the male air fitting (item 12) on the pneumatic swivel (item 18) of the tool. Next thread an air fitting of the proper style to the end of the air hose assembly to enable it to be connected to the air supply.

If the PR0003 combination air regulator/filter/lubricator is being used, the air hose of the PD9 should be connected to the "out" port of the regulator, and the air supply connected to the "in" port.

Once connected to the air supply, the unit is activated by depressing the handle. When the handle is released the unit will stop automatically. The handle may be adjusted for

the maximum desired opening for operator comfort. To do this, adjust the handle position set screw (item 22) to the desired open position.

The speed of the PD9 is pre-set at the factory. Although it is not recommended, the speed of the motor may be adjusted.

! CAUTION: THE PD9 MOTOR SPEED SHOULD NEVER EXCEED 15,000 RPM.

If it is necessary to adjust the motor speed, locate the motor speed adjustment screw (item 17). First loosen the locking set screw (item 13) with a 3/32" allen wrench. The motor speed adjustment screw may be turned clockwise or counter-clockwise to achieve the desired speed. Once the desired speed is attained, lock the motor adjusting screw with the set screw.

OPERATION: (Reference the diagram on page 5 for item callouts)

Operate the unit only after the above adjustments have been made.

! CAUTION: A FACE SHIELD AND SAFETY GLASSES OR OTHER SUITABLE EYE PROTECTION SHOULD BE WORN WHEN USING THIS UNIT.

The PD9 is rated for continuous operation. To strip a wire, position a wire to be stripped between the clamping pad and the stripping wheels up to the desired strip length. Depress the handle, clamping the wire and activating the unit, and pull the wire straight out as the wheels perform the stripping. If using a round wire, a twisting or rotating action may be necessary to strip all the way around the conductor. If using a square or rectangular wire, strip one side and repeat to complete stripping on all sides.

Utilize the entire 3/4" (19mm) face of the wire wheels whenever possible to avoid grooving of the wheels. If the stripping action of the standard wire wheels is too coarse, a different grade of wire wheels, or a Fybrglass® wheel may be used instead. See the Specifications section for more information on wheel grades and types.

MAINTENANCE: (Reference the diagram on page 5 for item callouts)

The PD9 should be lubricated daily or after 4 hours of operation with a turbine or spindle grade oil containing moisture absorbent and a rust inhibitor with a viscosity of 100-150 S.U.S. at 100°F. To lubricate, disconnect the air hose assembly from the unit and add 1-3 drops of oil directly into the air fitting of the PD9. The handle hinge pin

Model PD9 AIR-OPERATED PORTABLE WIRE STRIPPER

(item 9) should also be lubricated periodically using a drop of lightweight oil.

! CAUTION: WIRE BRISTLES ARE SHARP, AND WILL PENETRATE SKIN. USE CAUTION WHEN REMOVING WHEEL SECTIONS FROM THE SPINDLE.

Replace stripping wheels when worn. To replace the wheels, disconnect the PD9 from the air supply and remove the three (3) screws (item 15) holding the guard onto the unit. Remove the guard (item 2) exposing the spindle arbor and spindle nut (items 3 & 14). While holding the spindle in place with a 7/16" wrench, use a 9/16" wrench to remove the spindle nut. Slide the existing wheel(s) off the spindle and replace with four new wire wheel sections or one Fybrglass® wheel. Replace and tighten the spindle nut and replace the guard.

TROUBLESHOOTING: (Reference the diagram on page 5 for item callouts)

PROBLEM: Clamp handle will not contact wire.

SOLUTIONS:

- 1) Readjust clamping assembly adjustment screw (reference the Set-Up section).
- 2) Check to insure the motor trigger (item 21) is not preventing full handle actuation.
- 3) Check to insure that wheels (item 20) have not been worn beyond contact point with wire.
- 4) Check to insure clamping pad (item 6) is properly secured with the clamping pad screws (item 16).

PROBLEM: Motor does not run.

SOLUTIONS:

- 1) Check to insure that air supply is adequate, at 90 PSI @ 32CFM.
- 2) Check to insure that the motor trigger (item 21) is being depressed by handle actuation.
- 3) Check the motor speed adjustment screw (item 17) to insure that it is allowing enough air into the unit to run properly. To open the motor speed screw, turn it counter-clockwise until the motor runs at a proper speed.

! CAUTION: THE PD9 MOTOR SPEED SHOULD NEVER EXCEED 15,000 RPM.

- 4) Check the clamp pressure, as too much pressure on the wheels will stall the motor.

PROBLEM: Machine breaks wire

SOLUTIONS:

- 1) Check that the wire is not being clamped too tightly.
- 2) Insure that the wire is being pulled straight out during stripping without causing undue stress.
- 3) Try a less coarse stripping wheel.

PROBLEM: Wire does not strip

SOLUTIONS:

- 1) Check that there is sufficient clamping pressure on the wire.
- 2) Check that the wheels are not worn beyond contact point with the wire.
- 3) Check the grade of wheel and use a more coarse wheel if necessary.

IMPORTANT: NO LIABILITY WILL BE INCURRED BY THE ERASER COMPANY FOR INJURY, DEATH, OR PROPERTY DAMAGE CAUSED BY A PRODUCT WHICH HAS BEEN SET UP, OPERATED, AND/OR INSTALLED CONTRARY TO ERASER'S WRITTEN OPERATING MANUAL, OR WHICH HAS BEEN SUBJECTED TO MISUSE, NEGLIGENCE, OR ACCIDENT, OR WHICH HAS BEEN REPAIRED OR ALTERED BY ANYONE OTHER THAN ERASER, OR WHICH HAS BEEN USED IN A MANNER OR FOR A PURPOSE FOR WHICH THE PRODUCT WAS NOT DESIGNED.

Model PD9 AIR-OPERATED PORTABLE WIRE STRIPPER

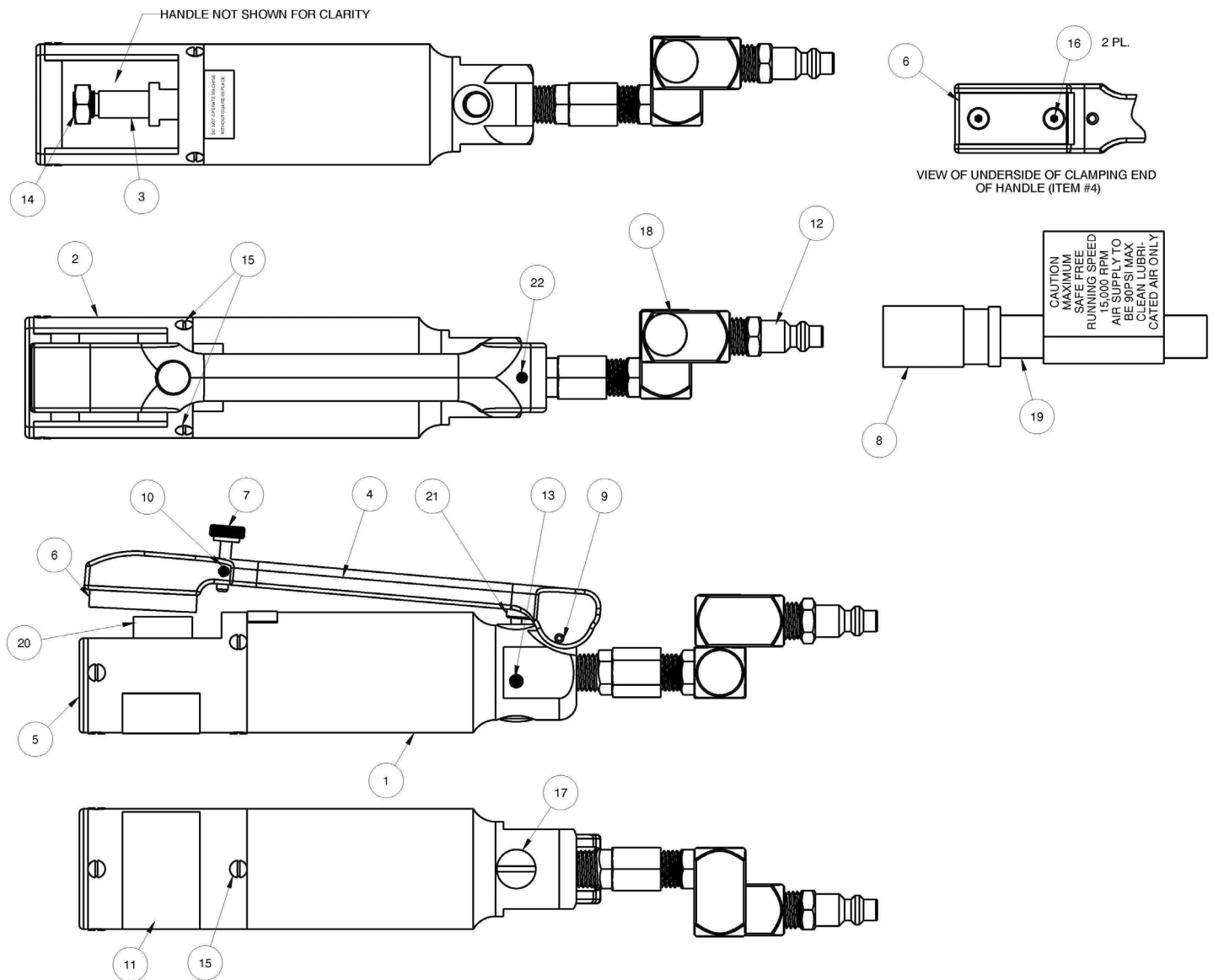

- | | |
|--|----------------------------------|
| 1. Motor Housing | 15. Guard Screws |
| 2. Guard Assembly | 16. Clamping Pad Screws |
| 3. Spindle Arbor | 17. Motor Speed Adjustment Screw |
| 4. Handle | 18. Pneumatic Swivel |
| 5. Guard End Cap | 19. Air Hose Assembly |
| 6. Steel Clamping Pad | 20. Stripping Wheels |
| 7. Clamping Assembly Adjustment Screw | 21. Motor Trigger |
| 8. Quick Disconnect Coupling | 22. Handle Position Set Screw |
| 9. Handle Hinge Pin | |
| 10. Set Screw (to lock Clamping Assembly Adjustment Screw) | |
| 11. Label | |
| 12. Male Air Fitting | |
| 13. Set Screw (to lock Motor Speed Adjustment Screw) | |
| 14. Spindle Nut | |
- Not Shown:
 Allen Wrench

The Eraser Company, Inc.
 PO Box 4961/ Oliva Drive
 Syracuse, NY 13221, USA



Phone: (315) 454-3237
 Fax: (315) 454-3090
 Website: www.eraser.com
 E-mail: info@eraser.com